



Explosion proof ballast box

Application

BC9100 Can be used in Zone 1 and Zone 2 indoor or outdoor where potentially explosive gas exist.

Characteristics of performance

- Equipped with international famous brand light source and electrical appliance, more stable performance and gives approximately 20% more light over the other manufacturer's.
- The average life span of the light source is more than 10000 hours. Therefore it is low maintenance .
- Two Explosion-proof cavities structure. The wiring cavity is separated from the main flameproof cavity, enhancing safety.
- Made of aluminium alloy, high strength. The spray coating treatment ensure the lamp waterproof, anti corrosion.

Main specification

Input Voltage	AC220V 50Hz (60Hz Option)
Ingress Protection	IP65
Anti Corrosion Grade	WF2
Insulation Grade	I
Space Height Ratio	2.6
Thread	G3/4"
Leading-in cable diameter	φ 8mm - φ 10mm
Dimension	Lamp 400 × 266 × 170mm
	Ballast 340 × 220 × 88mm
Net Weight	Lamp 5Kg
	Ballast 5.2Kg

Ex Code: Ex de II B T5
Ex de II B T4
Standard: GB3836.1, GB3836.2, GB3836.3
IEC60079-1:2007,MOD
IEC60079-7:2006,MOD



Light distribution curve

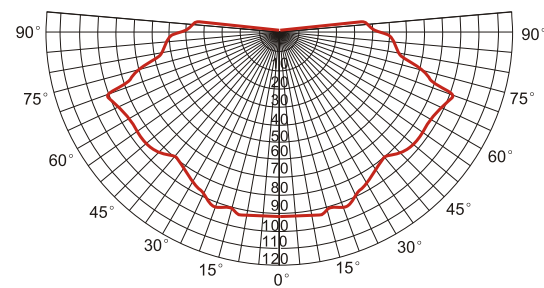

cd/1000lm

Ordering reference

Ordering Reference	Light Source	Wattage (W)	Luminous Flux (lm)	Lamp Average Life (h)	Temperature
BC9100-J70	MH	70	5,500	10,000	T5
BC9100-J100	MH	100	9,000	10,000	T4
BC9100-J150	MH	150	13,000	10,000	T4
BC9100-N70	HPS	70	6,000	28,500	T5
BC9100-N100	HPS	100	9,600	28,500	T4
BC9100-N150	HPS	150	16,000	28,500	T4

Drawing of dimension(Dimensions in mm)

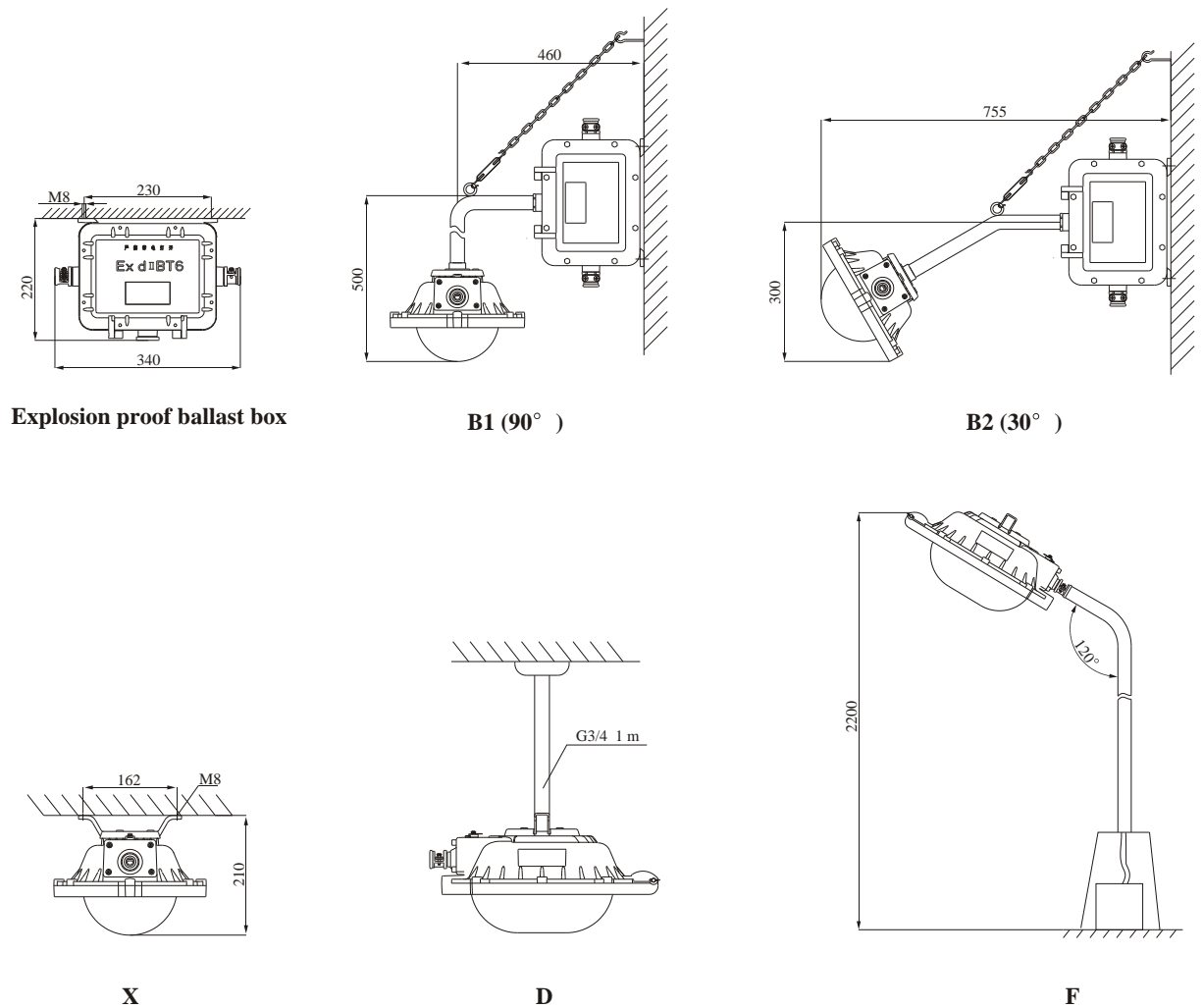

Explosion proof ballast box

B1 (90°)

B2 (30°)

X

D

F